



Shropshire
Council

Shropshire Council

TOWN AND COUNTRY PLANNING ACT 1990

THE TOWN AND COUNTRY PLANNING (TREE PRESERVATION) (ENGLAND)
REGULATIONS 2012

TREE PRESERVATION ORDER

relating to

**Shropshire Council (Land North of Dove Close/Hexham Way,
Shrewsbury) TPO 2024**

Order Number: SC/00516/24

Town and Country Planning Act 1990
Shropshire Council (Land North of Dove Close/Hexham Way,
Shrewsbury) TPO 2024

The Shropshire Council, in exercise of the powers conferred on them by section 198 of the Town and Country Planning Act 1990 make the following Order—

Citation

1. This Order may be cited as the Shropshire Council (Land North of Dove Close/Hexham Way, Shrewsbury) TPO 2024.

Interpretation

2. (1) In this Order “the authority” means the Shropshire Council

(2) In this Order any reference to a numbered section is a reference to the section so numbered in the Town and Country Planning Act 1990 and any reference to a numbered regulation is a reference to the regulation so numbered in the Town and Country Planning (Tree Preservation) (England) Regulations 2012.

Effect

3. (1) Subject to article 4, this Order takes effect provisionally on the date on which it is made

(2) Without prejudice to subsection (7) of section 198 (power to make tree preservation orders) or subsection (1) of section 200 (tree preservation orders: Forestry Commissioners), and subject to the exceptions in regulation 14, no person shall

(a) cut down, top, lop, uproot, wilfully damage or wilfully destroy; or

(b) cause or permit the cutting down, topping, lopping, uprooting, wilful damage or willful destruction of,

any tree specified in the Schedule to this Order except with the written consent of the authority in accordance with regulations 16 and 17, or of the Secretary of State in accordance with regulation 23, and, where such consent is given subject to conditions, in accordance with those conditions.

Application to trees to be planted pursuant to a condition

4. In relation to any tree identified in the first column of the Schedule by the letter “C”, being a tree to be planted pursuant to a condition imposed under paragraph (a) of section 197 (planning permission to include appropriate provision for preservation and planting of trees), this Order takes effect as from the time when the tree is planted.

**THE COMMON SEAL of
The SHROPSHIRE COUNCIL**

Dated this 22nd January 2024

Signed: *T. Darke*

On behalf of: Tracy Darke – Assistant Director Economy and Place
Shropshire Council, Shirehall, Abbey Foregate, Shrewsbury, Shropshire SY2 6ND

By: Andrea King, Tree and Woodland Amenity Protection Officer, Authorised Officer

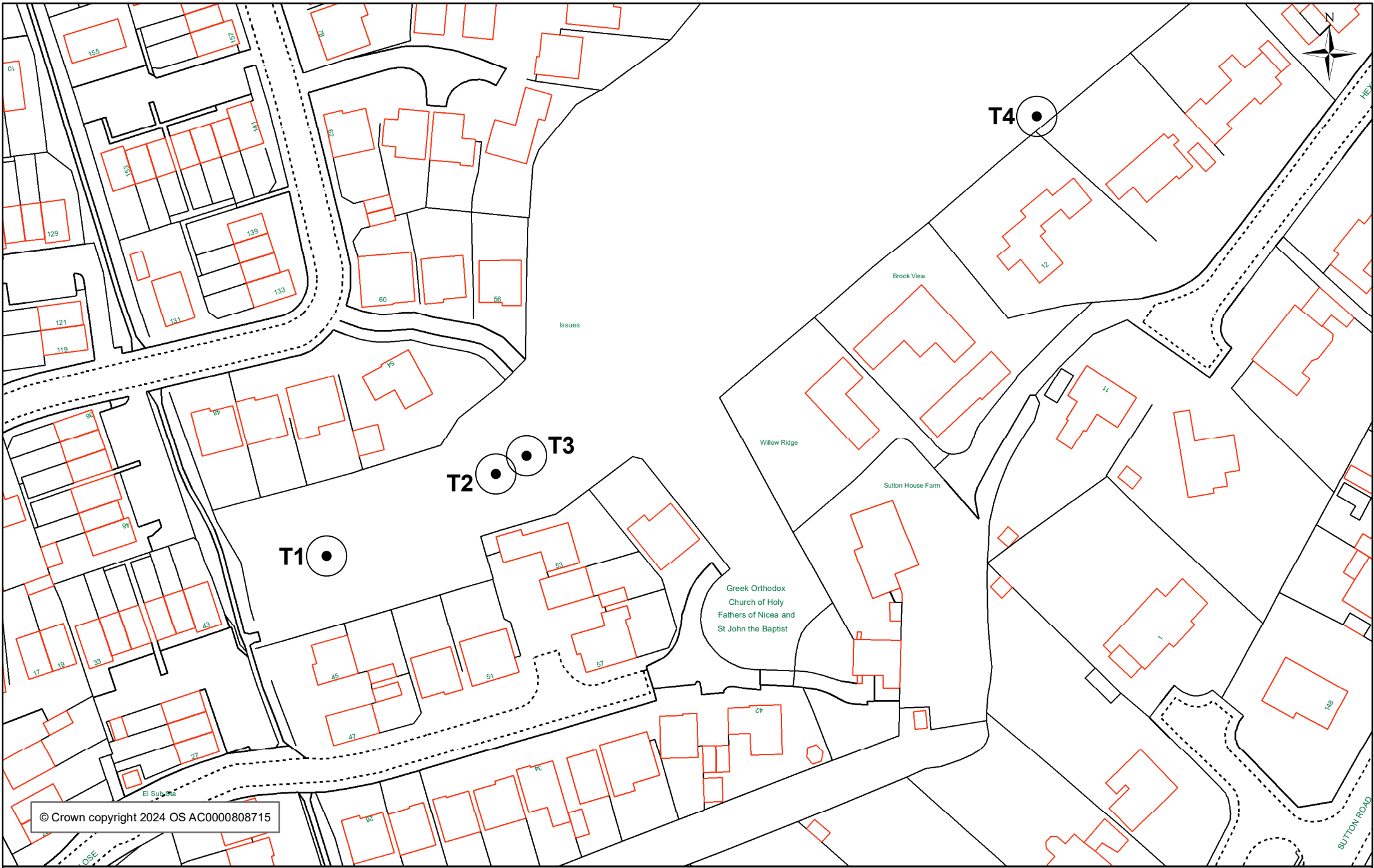

© Crown copyright 2024 OS AC0000808715



Shropshire Council (Land North of Dove Close/Hexham Way, Shrewsbury) TPO 2024

Shropshire Council
The Shirehall, Abbey Foregate,
Shrewsbury, Shropshire, SY2 6ND
Scale : 1:1,000

SCHEDULE 1

SPECIFICATION OF TREES

TREES SPECIFIED INDIVIDUALLY (encircled in black on map)

Map ref	Description;	Situation
T1	Sycamore	Land north of 45 Dove Close at grid ref Easting:35014, Northing:31049.

Map ref	Description;	Situation
T2	Lime	Land north of 53 Dove Close at grid ref Easting:35023, Northing:31054.

Map ref	Description;	Situation
T3	Lime	Land north of 53 Dove Close at grid ref Easting:35018, Northing:31051.

Map ref	Description;	Situation
T4	Oak	Land north-west of 10 Hexham Way at grid ref Easting:35029, Northing:31058.

TREES SPECIFIED BY REFERENCE TO AN AREA (NONE)

GROUPS OF TREES (NONE)

WOODLANDS (NONE)